

A rare opportunity to acquire this super stylish and substantial, double fronted apartment perfectly positioned on Henshelwood Terrace within Jesmond's Brandling Village Conservation Area. Henshelwood Terrace, a cobbled cul-de-sac, is ideally placed in Jesmond, just off Tankerville Terrace and within walking distance to some of the region's finest independent schools, the cafés of Clayton Road, Jesmond Metro Station and indeed Newcastle City Centre itself.

Located on the ground floor of this imposing conversion and having undergone a tasteful transformation by the current owners, the accommodation boasting close to 1,400 Sq ft briefly comprises: communal entrance hall with secure telephone entry system; private entrance hall with storage cupboard; 20ft sitting room with walk in bay, feature fireplace and stripped wood flooring; an impressive kitchen diner with a range of fitted units, work surfaces, some integrated appliances, breakfasting island, open to breakfast room with Atrium sky light and sliding doors to the private rear yard; utility room; two shower rooms, both complete with three piece suites; two double bedrooms both with stripped wood flooring and bedroom one measuring 20ft, a mirroring the sitting room with walk in bay. Externally, all privately owned, a delightful south-west facing front garden laid mainly to lawn with two patio seating areas and an EV charging point and to the rear, two yard spaces, both enclosed with wall boundaries. A truly unique purchase opportunity for a range of perspective buyers, early viewings are deemed absolutely essential to appreciate the accommodation on offer.

Double Fronted Ground Floor Conversion Apartment | Rare Purchase Opportunity | Super Stylish | 1,381 Sq ft (128.3m²) | Two Double Bedrooms | 20ft Sitting Room | Kitchen Diner to Breakfast Room | Two Shower Rooms | Utility Room | Front Garden | Two Rear Yards | Conservation Area | Leasehold - Share of Freehold - 99 Years Remaining | Service Charge Ad-Hoc | Council Tax Band | EPC: D



GROUND FLOOR
1381 sq.ft. (128.3 sq.m.) approx.

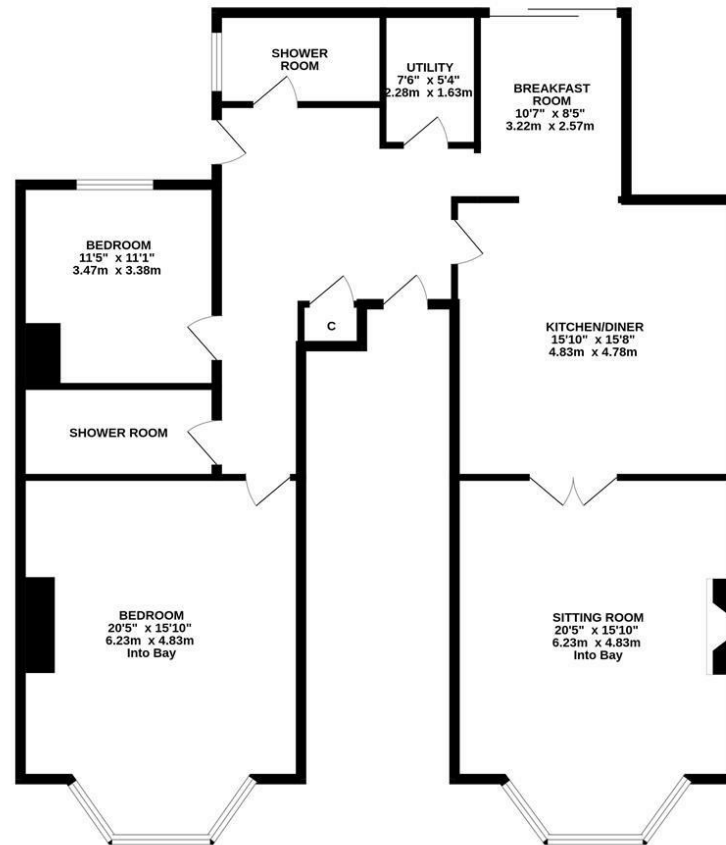

TOTAL FLOOR AREA: 1381 sq.ft. (128.3 sq.m.) approx.

Whilst every attempt has been made to ensure the accuracy of the floorplan contained herein, measurements of doors, windows, rooms and any other items are approximate and no responsibility is taken for any error, omission or mis-statement. This plan is for illustrative purposes only and should be used as such by any prospective purchaser. The services, systems and appliances shown have not been tested and no guarantee as to their operability or efficiency can be given.
Made with Metropix ©2025.



Offers Over £450,000

IMPORTANT NOTE: These particulars and the descriptions and measurements herein do not constitute representation and whilst every effort has been made to ensure accuracy, this cannot be guaranteed.

